

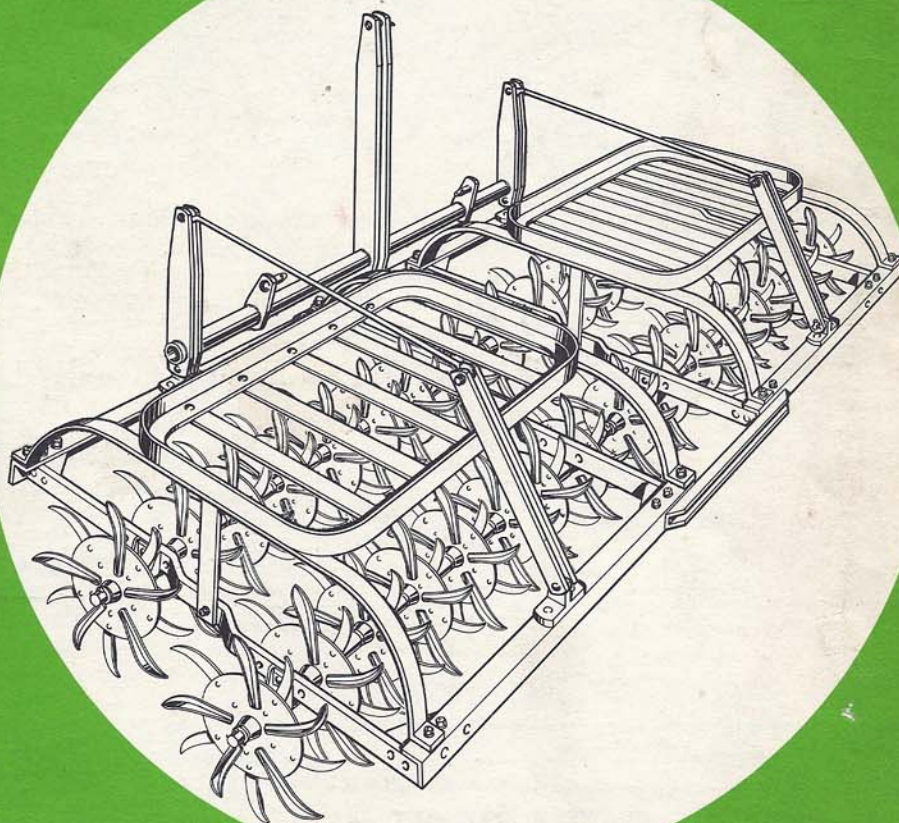

PARTS BOOK

FOR R-KO-20 ROTARY HOE



JUNE 1953

Harry Ferguson, Inc.

DETROIT MICHIGAN

R-KO-20 ROTARY HOE PARTS LIST

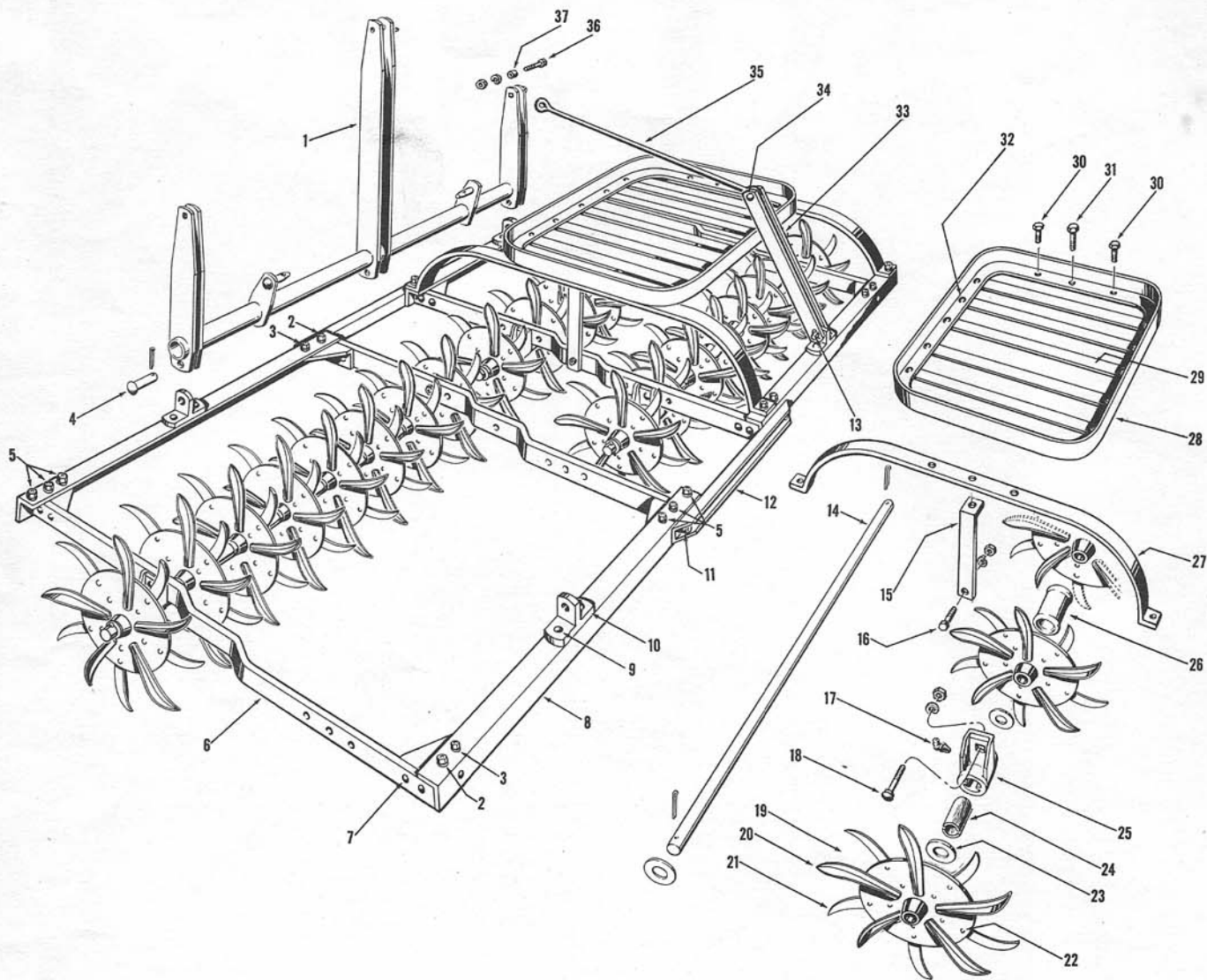

REF. NO.	PART NO.	DESCRIPTION	QUAN. REQ'D
1	R-KO-610	DRAWBAR ASSEMBLY	1
2	44-001-138	BOLT - Hex Head - Side Bar to End Angle to Support	4
	44-14	WASHER - Lock	4
	44-003	NUT - Hex	4
3	44-001-100	BOLT - Hex Head - Side Bar to End Angle	4
	44-14	WASHER - Lock	4
	44-003	NUT - Hex	4
4	S-9580	PIN - Section to Drawbar	2
	19-05-100	PIN - Cotter	2
5	44-001-100	BOLT - Hex Head - Side Bar to End Angle	12
	44-14	WASHER - Lock	12
	44-003	NUT - Hex	12
6	R-KO-7810	SIDE BAR ASSEMBLY - Main Frame	4
7	38-06-125	RIVET - Button Head - Side Bar to Corner Brace	16
8	R-KO-7801	MAIN FRAME - Angle Assembly - Includes items 9 and 10.	4

R-KO-20 ROTARY HOE PARTS LIST

REF. NO.	PART NO.	DESCRIPTION	QUAN. REQ'D
9	38-06-112	RIVET - Button Head - Plate to End Angle	8
10	R-KO-7803	PLATE - Frame Hitch	4
11	{ 44-001-125	BOLT - Hex Head - Connector Section to Main Frames.	4
	{ R-KO-7806	BUSHING - Section Connection - Shown in Position	4
12	{ 44-14	WASHER - Lock	4
	{ 44-003	NUT - Hex	4
13	R-KO-7945	CONNECTION - Section	2
14	{ R-KO-9728	PIN - Connecting Straps to Hitch Plate	2
	{ 19-05-100	PIN - Cotter	2
15	{ R-KO-7409	AXLE - Gang	4
	{ R-KO-9640	WASHER - Spider Retaining	8
16	{ 25-05-125	PIN - Cotter	8
	{ R-KO-7837	BRACE - Weight Box Support	4
17	{ 44-001-125	BOLT - Hex Head - Brace to Side Bar	4
	{ 44-14	WASHER - Lock	4
18	{ 44-003	NUT - Hex	4
	{ 12-3107	FITTING - Lubrication	8
19	{ 44-011-150	BOLT - Carriage - Bearing Box to Side Bar	8
	{ 44-14	WASHER - Lock	8
20	{ 44-003	NUT - Hex	8
	{ R-KO-202	SPIDER HUB AND TOOTH ASSEMBLY	32
		Composed of Hub which is not serviced and items 20, 21 and 22	
21	{ R-KO-157	TOOTH - Spider - L.H. - Stamping - Up to 2100 and 7000 & Future.	160
	{ R-KO-157-A	TOOTH - Spider - L.H. - Forged - Serial 2100 to 7000	160
22	{ R-KO-156	TOOTH - Spider - R.H. - Stamping - Up to 2100 and 7000 & Future.	160
	{ R-KO-156-A	TOOTH - Spider - R.H. - Forged - Serial 2100 to 7000	160
23	38-06-81	RIVET - Button Head - Tooth to Spider - Up to 2100 and 7000 & Future	640
24	R-KO-9641	WASHER - Thrust Bearing	16
25	R-KO-5580	BEARING - Wood - Half	16
26	R-KO-5578	BEARING - Box	8
27	R-KO-8067	SPACER - Spider	20
28	R-KO-7927-A	SUPPORT - Weight Box	4
29	R-KO-7830-A	WEIGHT BOX ASSEMBLY - Includes items 29 & 32	2
30	{ R-KO-8047-A	SLAT - Weight Box	5
	{ 44-001-100	BOLT - Hex Head - Weight Box to Support	8
	{ 44-14	WASHER - Lock - Not Illustrated	8
31	{ 44-003	NUT - Hex - Not Illustrated	8
	{ 44-001-125	BOLT - Hex Head - Weight Box to Support to Brace	4
	{ 44-14	WASHER - Lock - Not Illustrated	4
32	{ 44-003	NUT - Hex - Not Illustrated	4
	{ 38-06-88	RIVET - Button Head - Slat to Weight Box Angle	20
33	R-KO-7951-A	STRAP - Lift Rod Connecting	4
34	{ 44-06-150	RIVET - Button Head - Strap to Spacer to Strap	2
	{ S-10018	SPACER - Lift Rod to Connecting Strap - Shown in Position	2
35	{ R-KO-7950-A	ROD - Lift	2
	{ 44-001-150	BOLT - Hex Head - Drawbar to Bushing to Lift Rod	2
36	{ 44-14	WASHER - Lock	2
	{ 44-003	NUT - Hex	2
37	S-10018	SPACER - Lift Rod to Drawbar	2

A SYMBOL OF QUALITY



**USE ONLY
GENUINE FERGUSON
SERVICE PARTS**

Form 0-3338-B

LITHO IN U.S.A.